

# Venue List by Facility

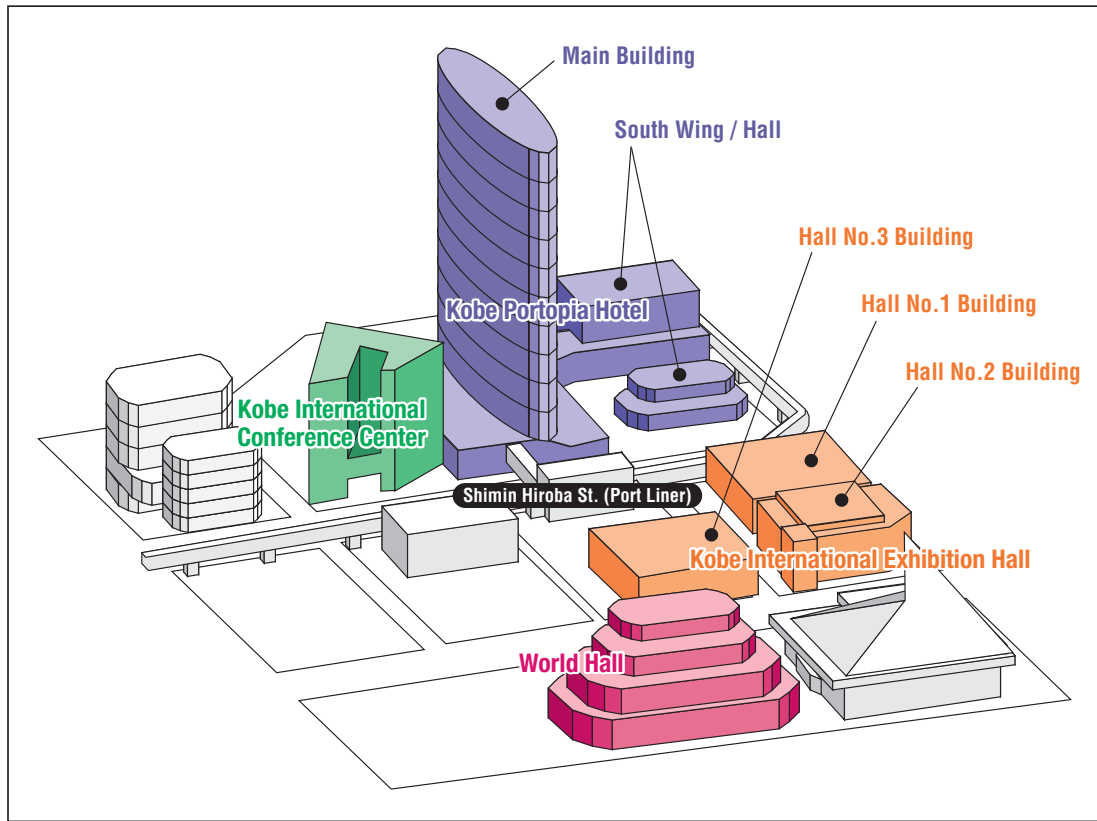

## Kobe Portopia Hotel (South Wing)

Room 1	1F	Portopia Hall
Room 2	1F	Ohwada A
Room 3	1F	Ohwada B
Room 4	1F	Ohwada C
Room 5	B1F	Topaz
Room 6	B1F	Emerald
Room 7	B1F	Diamond
Room 8	B1F	Ruby
PC Preview	1F	In front of Ohwada
Hotel Cloakroom	1F	
Exhibition Room 1	B1F	Sapphire

## Kobe Portopia Hotel (Main Bldg.)

Room 9	B1F	Kairaku 1-2
Room 10	B1F	Kairaku 3
Room 11	B1F	Waraku
PC Preview	B1F	In front of Kairaku
Hotel Cloakroom	B1F	
Congress Secretariat	B1F	Ikuta

## Kobe International Conference Center

Room 12	1F	Main Hall
Room 13	3F	International Conference Room
Room 14	4F	401+402
Room 15	5F	501
Room 16	5F	502
Room 17	5F	504+505
Hands-on Seminar	5F	503
PC Preview	3F	Foyer
Cloakroom	B1F	Rehearsal Room
Exhibition Room 2	4F	403

## World Hall

Poster	1F	Arena
EMPOWER Special Project		

## Kobe International Exhibition Hall (Hall No.1 Bldg.)

General Information	1F	Exhibition Room
Co-sponsored Seminar Ticket		
Congress Bag Distribution		
Cloakroom		
Room 18	2F	Exhibitor Hall A
Room 19	2F	Exhibitor Hall B

## Kobe International Exhibition Hall (Hall No.2 Bldg.)

Room 20	2F	2A Meeting Room
Room 21	3F	3A Meeting Room
Exhibition	1F	Convention Hall
PC Preview	1F	Foyer

## Kobe International Exhibition Hall (Hall No.3 Bldg.)

Exhibition	1F	Exhibition Room
------------	----	-----------------

# Floor Map

## Kobe Portopia Hotel (Main Bldg. / South Wing)

### Main Bldg. 1F

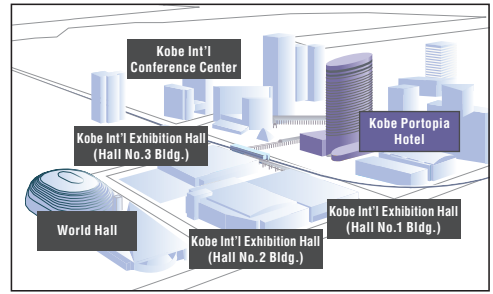
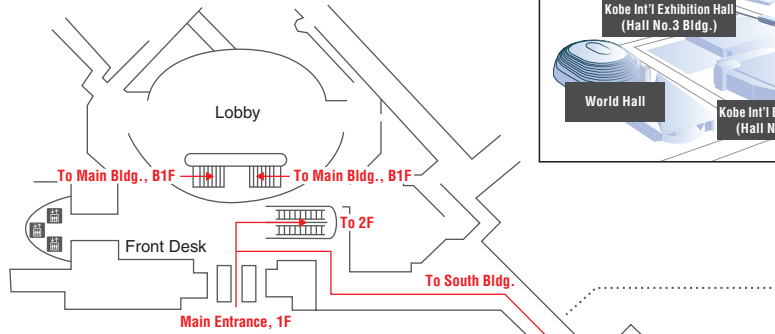

### South Wing 1F

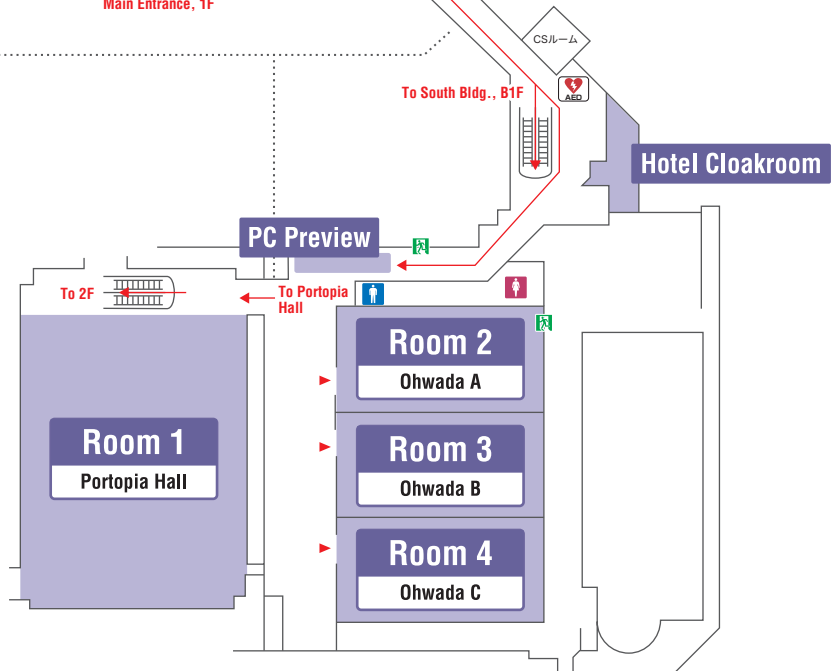

### South Wing B1F

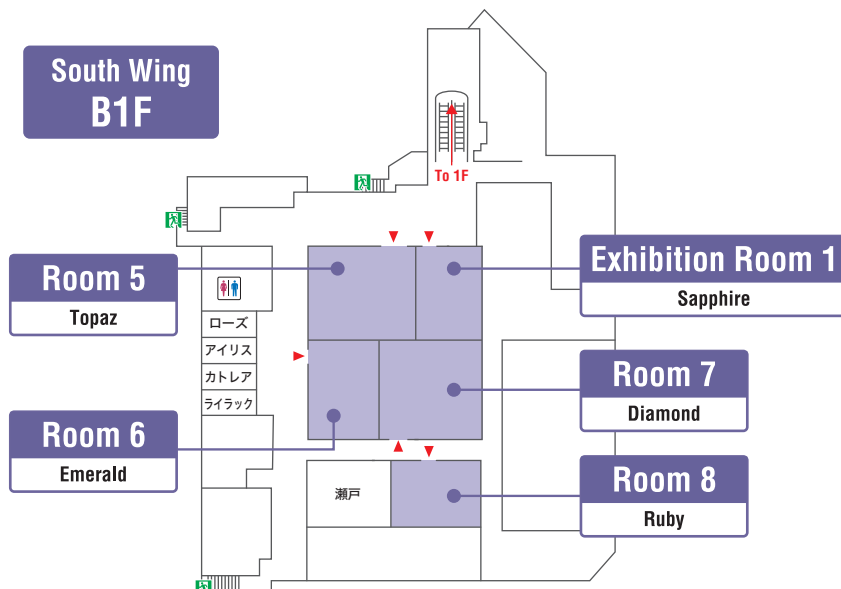

# Floor Map

## Kobe Portopia Hotel (Main Bldg.)

### Main Bldg. 2F

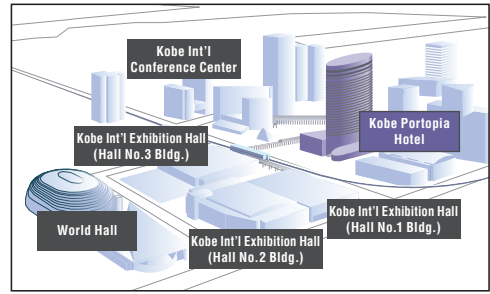
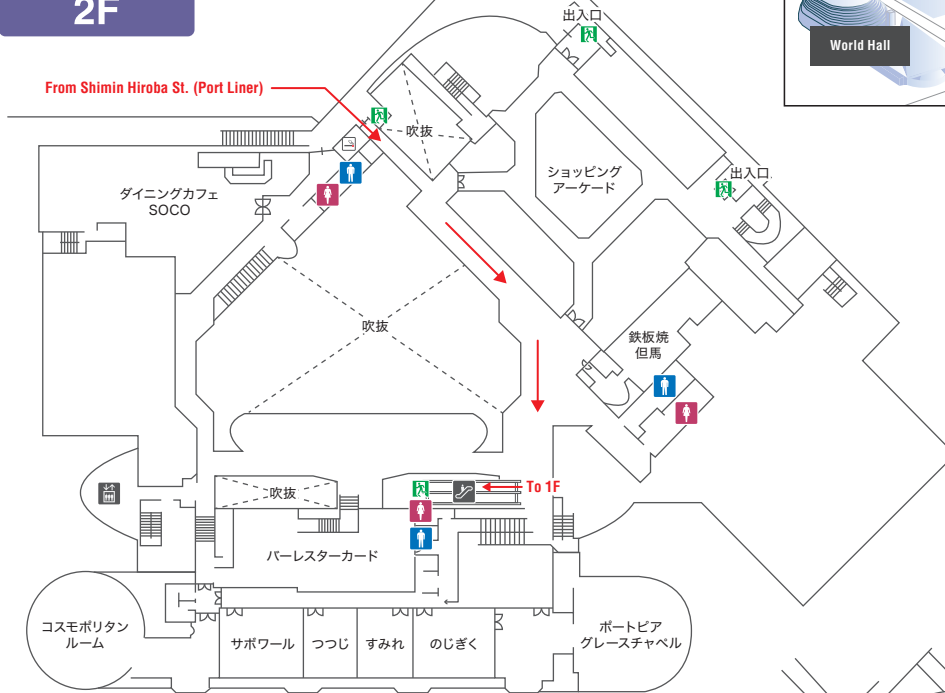

### Main Bldg. 1F

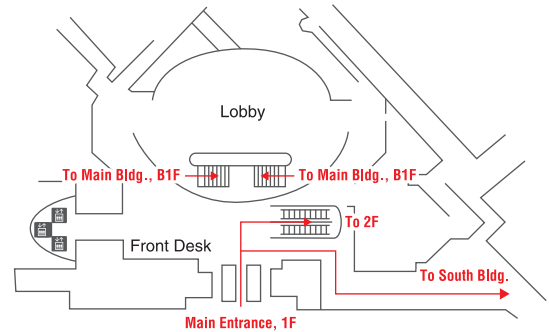

### Main Bldg. B1F

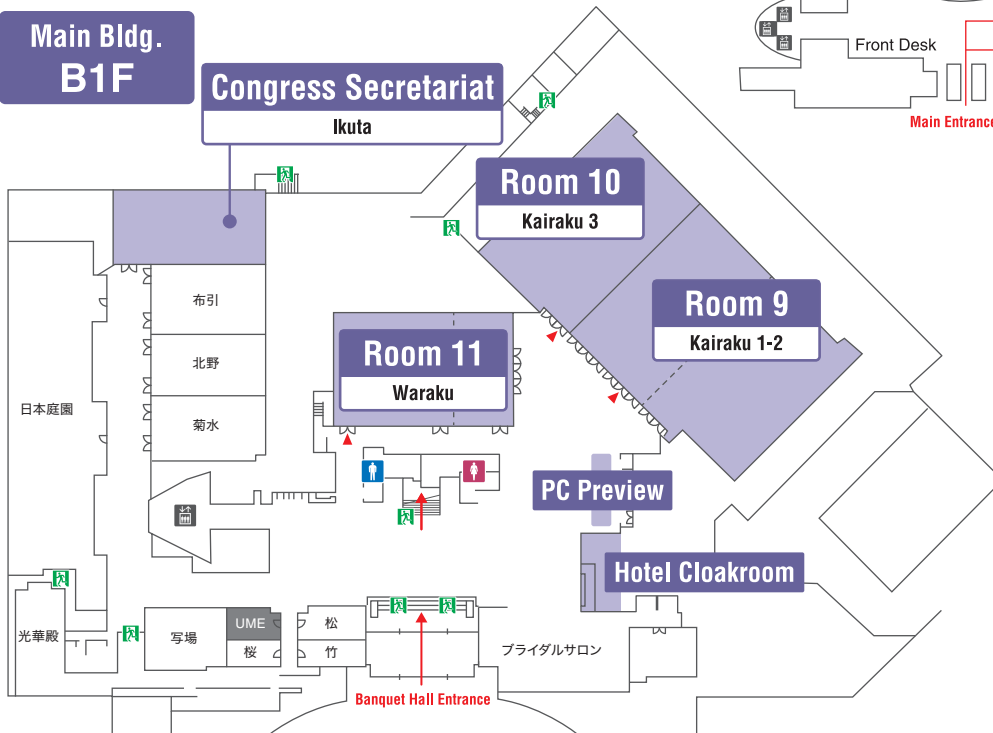

# Floor Map

## Kobe International Conference Center

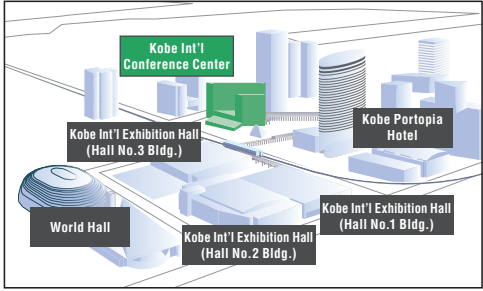
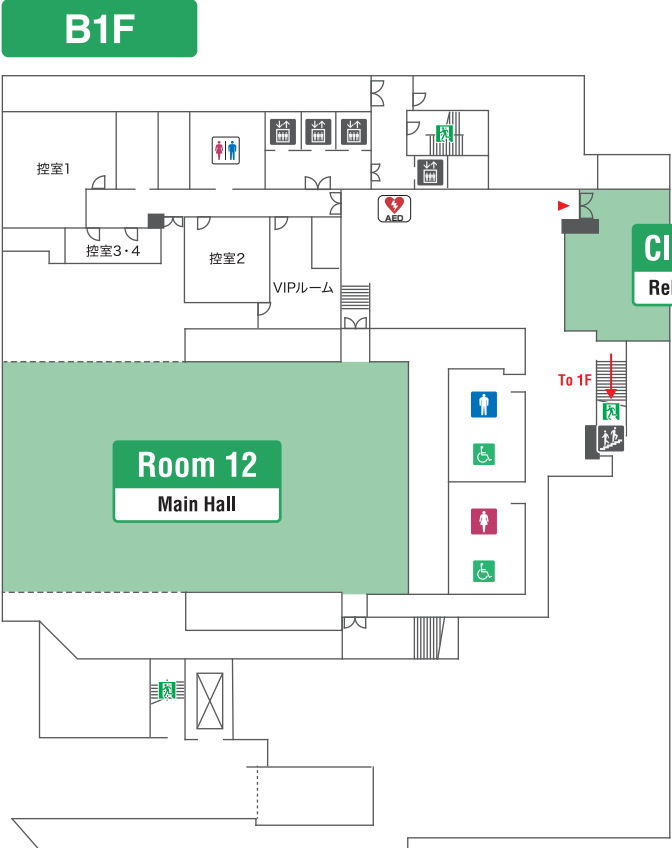

\*To access Room 12, please take the elevator to B1F and proceed via the stairs.

# Floor Map

## Kobe International Conference Center

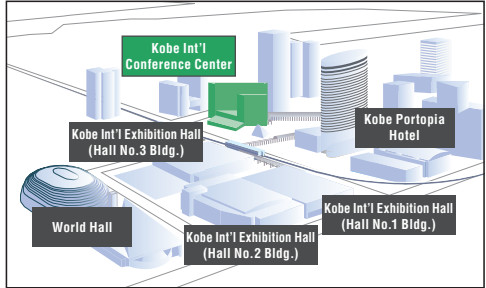

### 2 F

- B1F Cloakroom
- 1 F Room 12 \*To access 1F, please go through B1F.
- 3 F PC Preview, Room 13
- 4 F Room 14, Exhibition Room 2
- 5 F Room 15-17, Hands-on Seminar

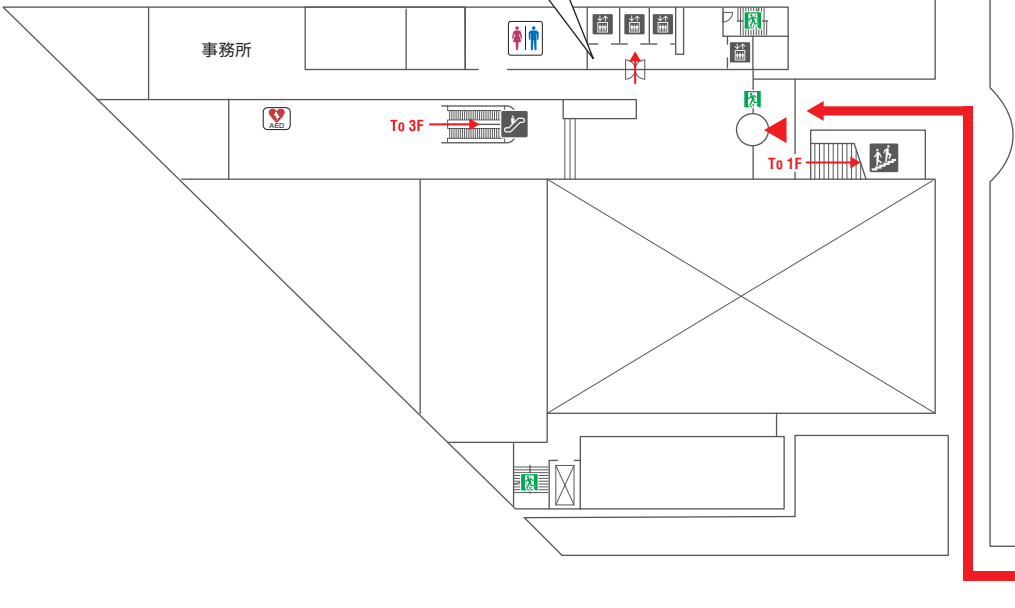

Shimin Hiroba St.  
Connecting Passage  
(2F Entrance)

### 3 F

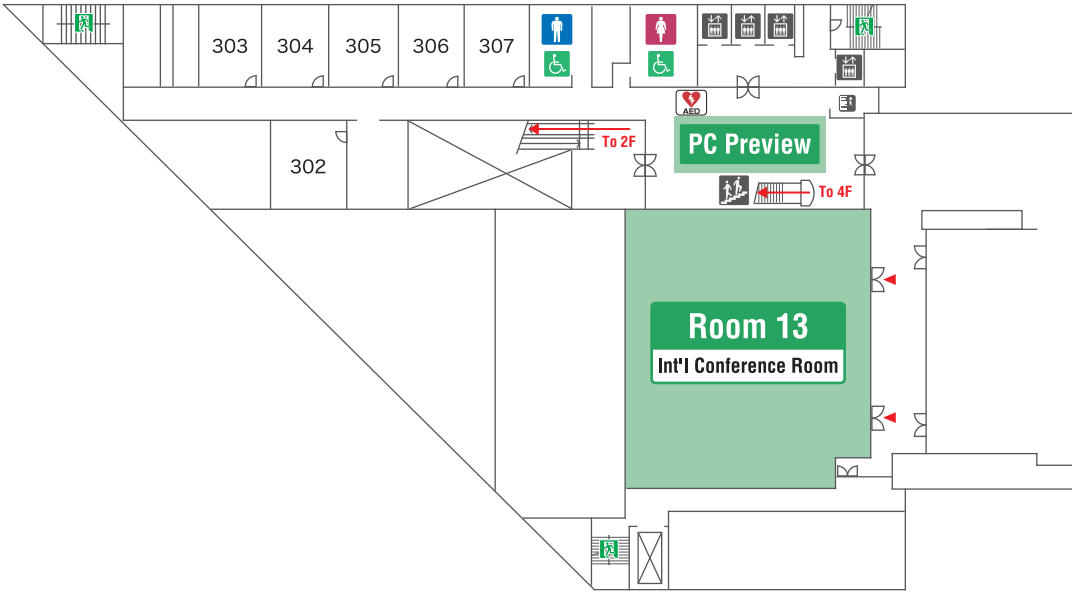

# Floor Map

## Kobe International Conference Center

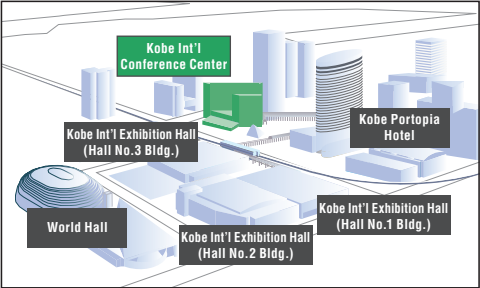

### 4 F

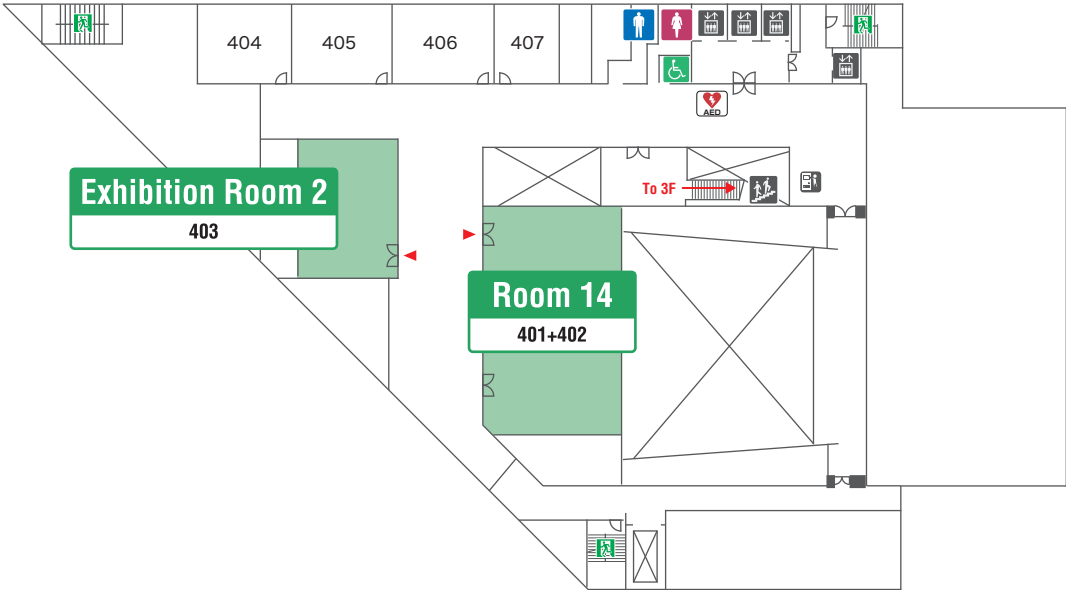

### 5 F

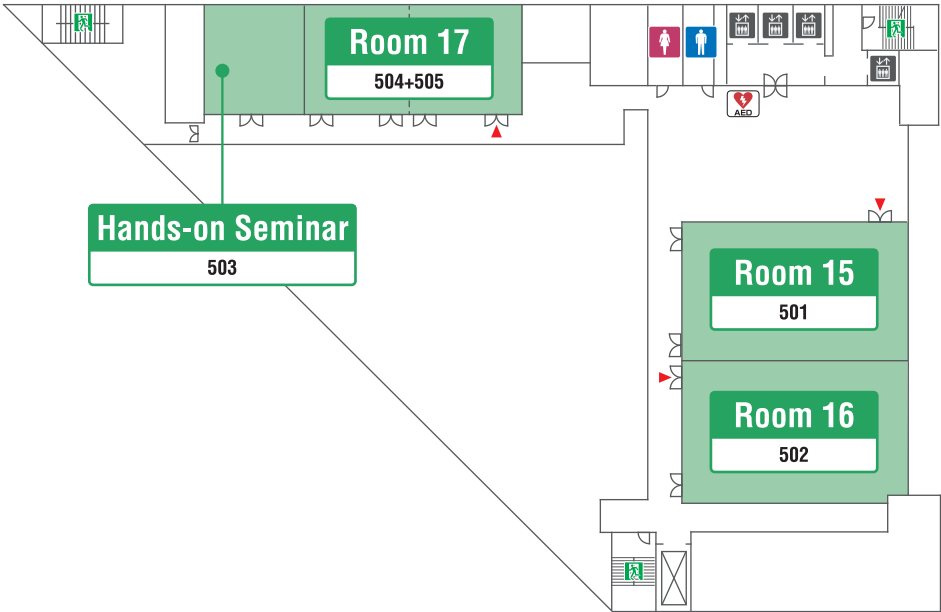

# Floor Map

## Kobe International Exhibition Hall

1 F

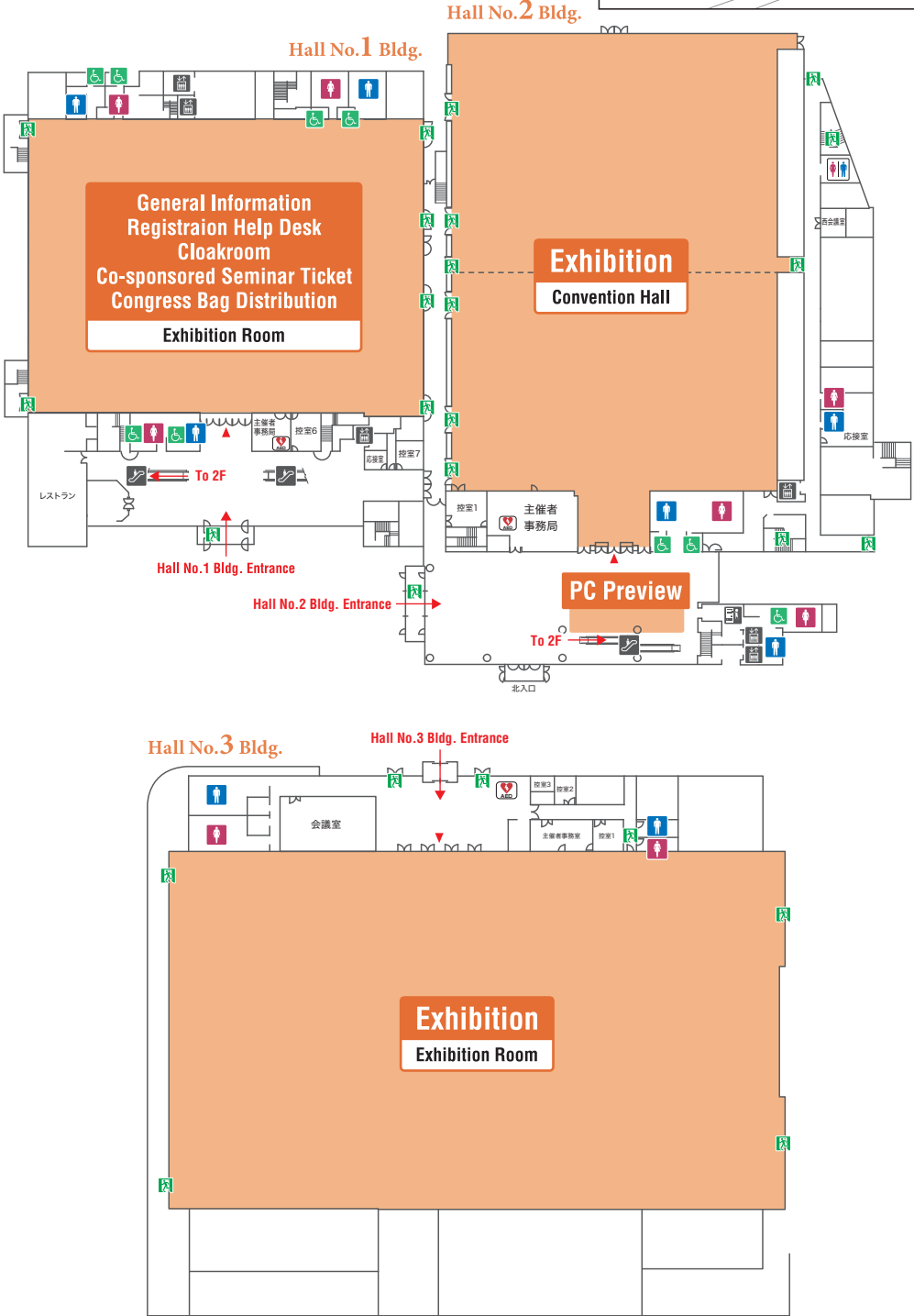
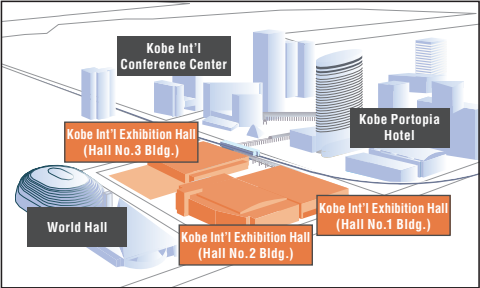

# Floor Map

## Kobe International Exhibition Hall

2 F



3 F

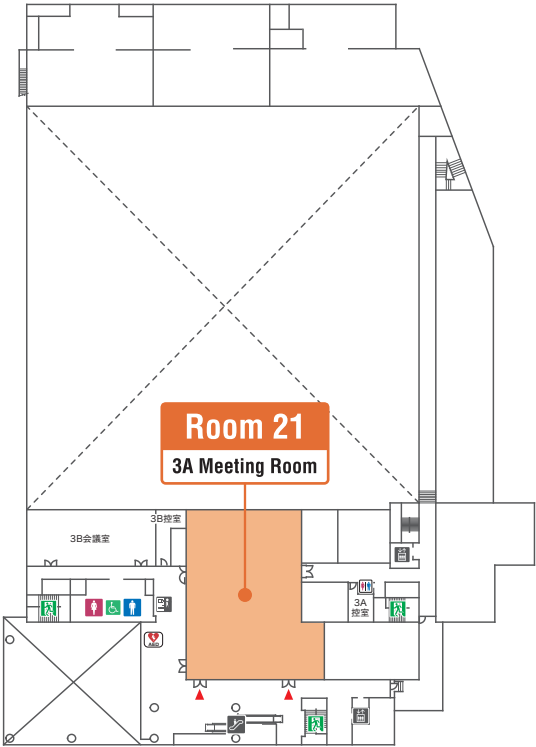

# Floor Map

## World Hall

